

**45° Male Elbow - NPT**

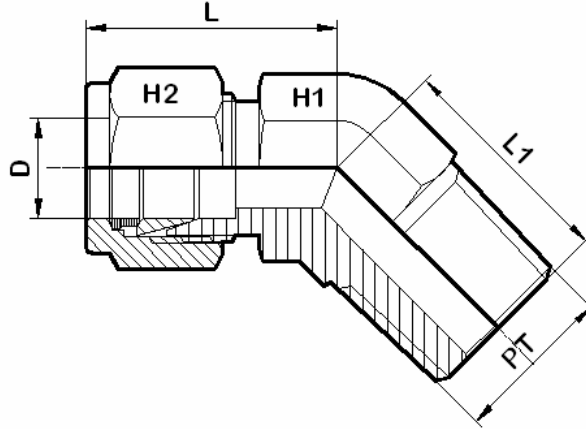

**For Fractional Tubes**

Apurva Code	D (in)	PT (NPT)	H1 (in)	H2 (in)	L	L1
4 A-45ME 4 N	1/4	1/4	19/32	9/16	24.5	21
6 A-45ME 6 N	3/8	3/8	11/16	11/16	28	24
8 A-45ME 8 N	1/2	1/2	7/8	7/8	32	29
12 A-45ME 12 N	3/4	3/4	1-1/16	1-1/8	34	31
16 A-45ME 16 N	1	1	1-3/8	1-1/2	40	38

**For Metric Tubes**

Apurva Code	D	PT (BSPT)	H1	H2	L	L1
6M A-45ME 4 N	6	1/4	15	14	25	21
10M A-45ME 6 N	10	3/8	17	19	29.5	24
12M A-45ME 8 N	12	1/2	22	22	33	29
16M A-45ME 8 N	16	1/2	24	25	35	29