

**Male Port Adapter**

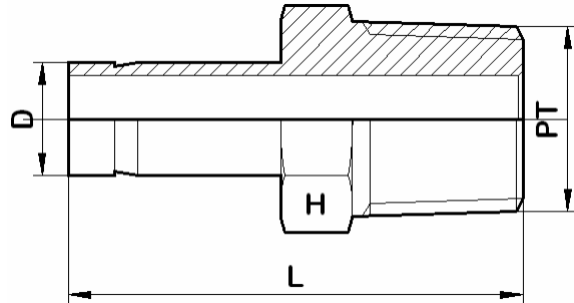

**For Fractional Tubes**

Apurva Code	D (in)	PT (NPT)	H (in)	L
2 A-MPA 2 N	1/8	1/8	7/16	29.5
2 A-MPA 4 N	1/8	1/4	9/16	35
3 A-MPA 2 N	3/16	1/8	7/16	30.2
3 A-MPA 4 N	3/16	1/4	9/16	35.6
4 A-MPA 2 N	1/4	1/8	7/16	31.8
4 A-MPA 4 N	1/4	1/4	9/16	37
4 A-MPA 6 N	1/4	3/8	11/16	37.9
4 A-MPA 8 N	1/4	1/2	7/8	43.4
5 A-MPA 2 N	5/16	1/8	7/16	32.8
5 A-MPA 4 N	5/16	1/4	9/16	38.1
6 A-MPA 2 N	3/8	1/8	7/16	33.5
6 A-MPA 4 N	3/8	1/4	9/16	38.9
6 A-MPA 6 N	3/8	3/8	11/16	39.6
6 A-MPA 8 N	3/8	1/2	7/8	45.2
8 A-MPA 4 N	1/2	1/4	9/16	44.5
8 A-MPA 6 N	1/2	3/8	11/16	45.2
8 A-MPA 8 N	1/2	1/2	7/8	50.5
10 A-MPA 6 N	5/8	3/8	11/16	47.4
10 A-MPA 8 N	5/8	1/2	7/8	52.3
10 A-MPA 12 N	5/8	3/4	1-1/16	52.3
12 A-MPA 8 N	3/4	1/2	7/8	52.3
12 A-MPA 12 N	3/4	3/4	1-1/16	52.3
12 A-MPA 16 N	3/4	1	1-3/8	58
14 A-MPA 12 N	7/8	3/4	1-1/16	54.3
16 A-MPA 12 N	1	3/4	1-1/16	58.7
16 A-MPA 16 N	1	1	1-3/8	66

**Male Port Adapter**

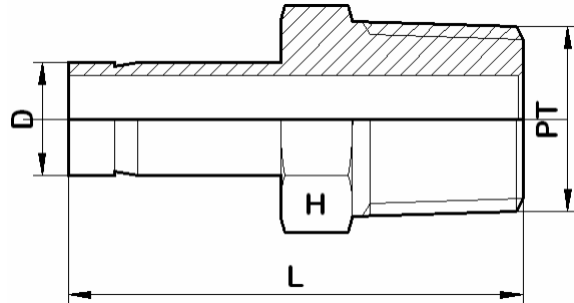

**For Metric Tubes**

Apurva Code	D (in)	PT (NPT)	H (in)	L
3M A-MPA 2 N	3	1/8	12	29.5
6M A-MPA 2 N	6	1/8	12	33
6M A-MPA 4 N	6	1/4	14	38
8M A-MPA 4 N	8	1/4	14	39
10M A-MPA 4 N	10	1/4	14	40
10M A-MPA 6 N	10	3/8	17	40.7
10M A-MPA 8 N	10	1/2	22	45.3
12M A-MPA 4 N	12	1/4	14	46.5
12M A-MPA 6 N	12	3/8	17	46.2
12M A-MPA 8 N	12	1/2	22	52
18M A-MPA 8 N	18	1/2	22	53.4
18M A-MPA 12 N	18	3/4	27	53.4